

DRAWING FOR CUSTOMER

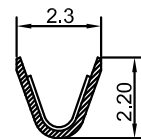
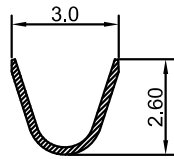
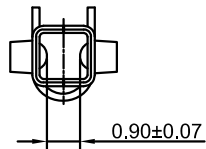
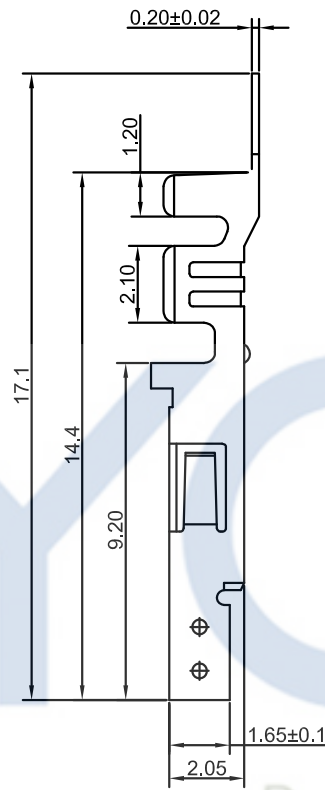
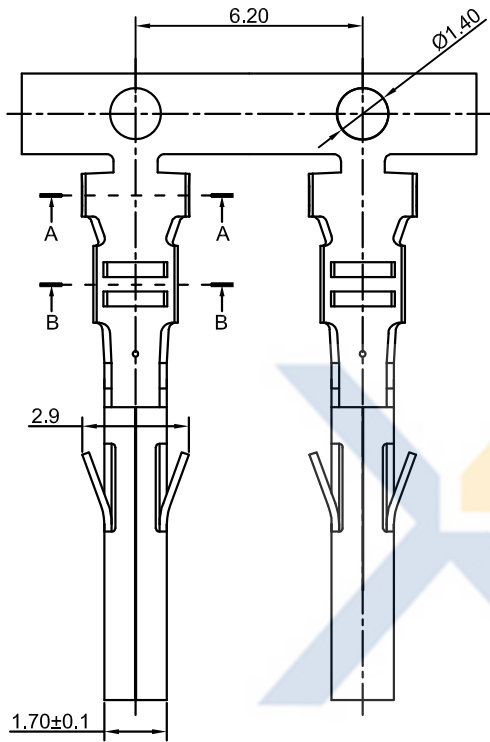

SECTION A-A

SECTION B-B

- SPEC.:
- Rated Voltage:600V AC,DC
 - Rated Current:9A AC,DC
 - Withstand Voltage:1500V AC/minute
 - Insulation Resistance:1000MΩ min
 - Contant Resistance:20mΩ Max.
 - Temperature Range:-25℃~+85℃

- Terminal
- Material:Brass
 - Finish:Tin-plated,over Nickel
 - Applicable wire:AWG#20~24

KB970-XXXT5A

- 1:All plated
- 2:Half plated

Plating

- 0: Tin-plat
- 1: Gold Plat1u"
- 2: Gold Plat3u"
- 3: Gold Plat5u"
- 8: Gold Plat8u"

Version

Mold No.

Terminal

XYCO PRECISION CONNECTORS

TEL: 0769-8297 9981/2/3 <http://www.XYCO.com.cn>

					TOLERANCE 公差	DRAWING 设计者	John	KB970-XXT5A	
2013-07-30	A		KB970-XXT5A	John	.X=±0.30 .XX=±0.20 .XXX=±0.10	CHECKED 审查	Thomas	PART NO. 料号	
DATE 日期	VER 版本	CHANGE HISTORY 变更历史	CHANGED NAME 修改后料号	DRAWING 变更者		APPROVED 核准	William	DWG NO. 图号	PE1811005A

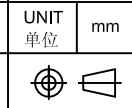

PRODUCT NAME
产品名称

MOLEX 4.2mm Terminal-Female