

DRAWING FOR CUSTOMER

- SPEC.:
- Rated Voltage:200V AC,DC
 - Rated Current:1.5A AC,DC
 - Withstand Voltage:1000V AC/minute
 - Contact Resistance:20mΩ max
 - Insulation Resistance:1000MΩ min
 - Temperature Range:-25℃~+85℃

- Terminal:
- Material:Phosphor Bronze
 - Finish:Gold/Tin-plated,over Nickel
 - Applicable wire:AWG#26~28
 - QTY.:15KPCS/Reel

KB9110-XXT3A

- 1:All plated
- 2:Half plated

Plating

- 0: Tin-plated
- 1: Gold Plated1u"
- 2: Gold Plated3u"
- 3: Gold Plated5u"

Version

Mold No.

Terminal

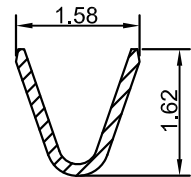
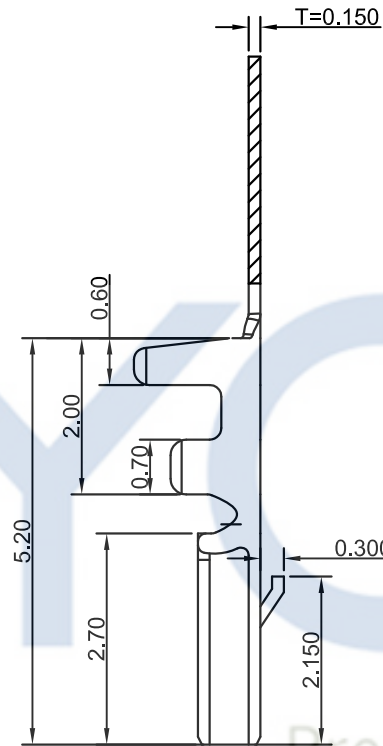
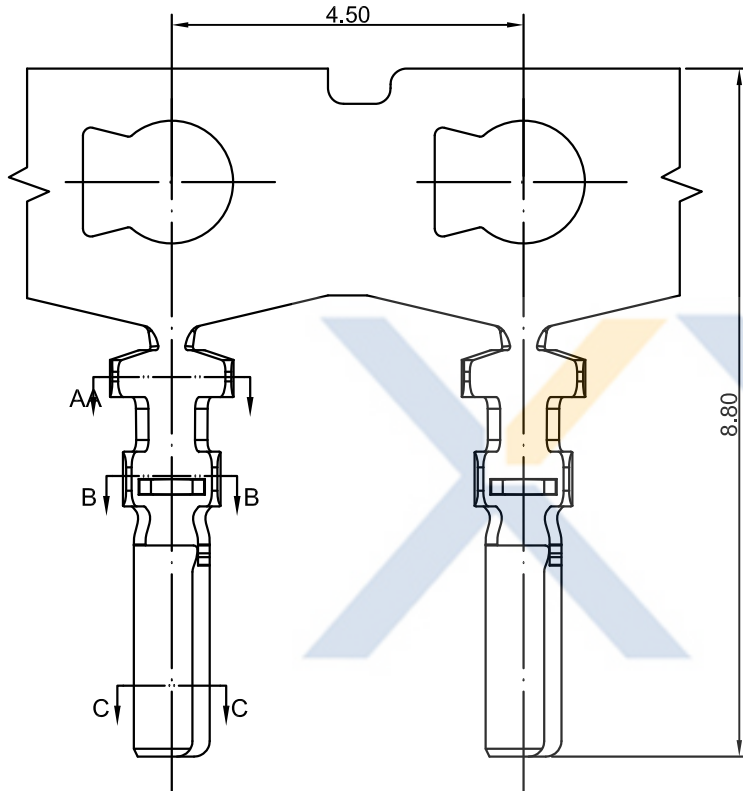
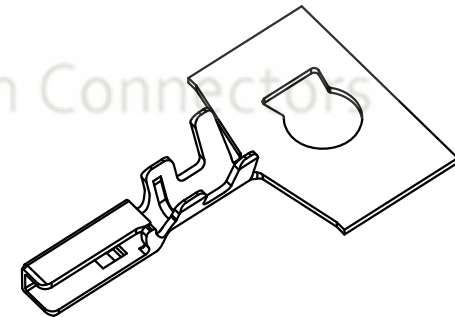

SECTION: A-A
SCALE: 1:1

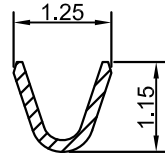

SECTION: B-B
SCALE: 1:1

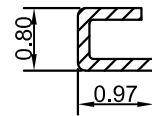

SECTION: C-C
SCALE: 1:1

XYCO 东莞市轩业电子科技有限公司
TEL: 0769-8297 9981/2/3 <http://www.XYCO.com.cn>

				TOLERANCE 公差		DRAWING 設計者		Devin		KB9110-XXT3A				
2015-6-18		A		.X=±0.30 .XX=±0.20 .XXX=±0.10		CHECKED 審查		Thomas		PART NO. 料號				
DATE 日期	VER 版本	CHANGE HISTORY 變更歷史	CHANGED NAME 修改後料號	DRAWING 變更者	APPROVED 核准		William		DWG NO. 圖號	PE1803013A	UNIT 單位	mm	PRODUCT NAME 產品名稱	104521 PH1.25mm Wire To Board Wire To Board Terminal