

DRAWING FOR CUSTOMER

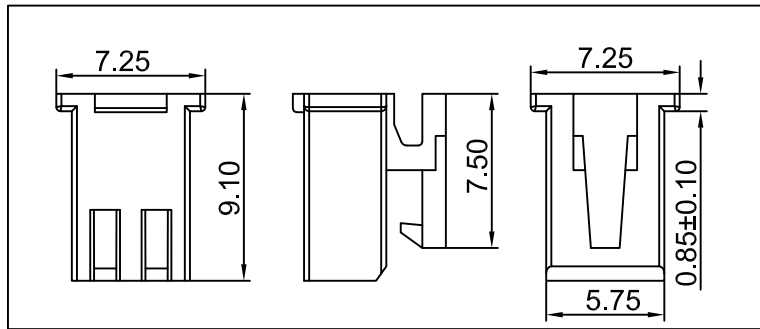
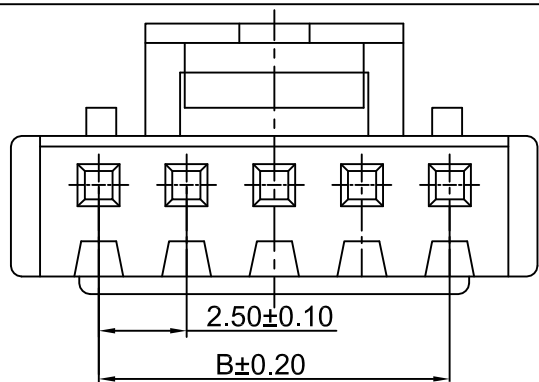

- SPEC.:
- Rated Voltage:250V AC,DC
 - Rated Current:3A AC,DC
 - Withstand Voltage:1000V AC/minute
 - Contact Resistance:40mΩ max
 - Insulation Resistance:1000MΩ min
 - Temperature Range:-25°C~+85°C

- Material:
- Insulator:PA66 UL94V-0
 - Color:White

02P

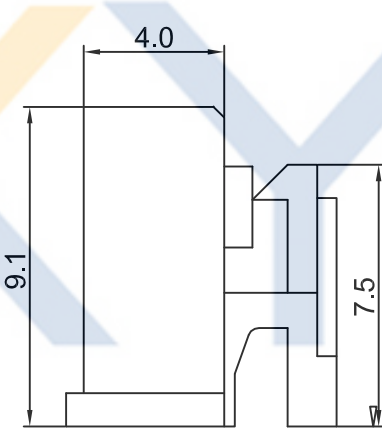
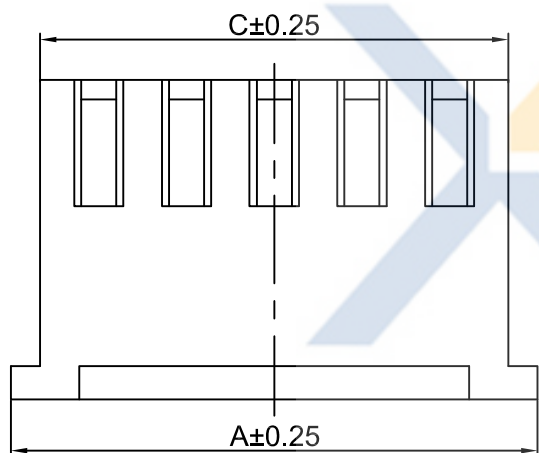
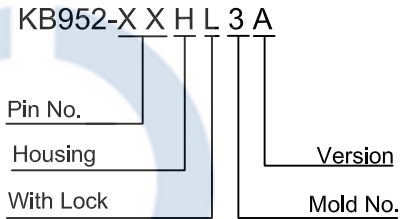

03-16P

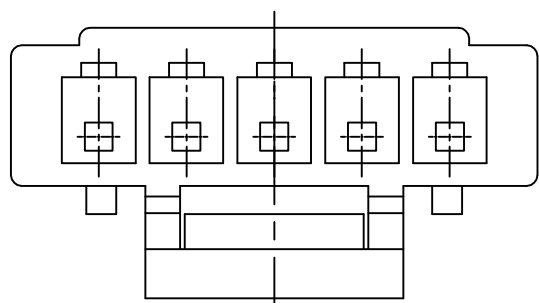

Poles	Dimensions (mm)			Poles	Dimensions (mm)		
	A	B	C		A	B	C
02	7.25	2.50	5.75	10	27.25	22.50	25.75
03	9.75	5.00	8.25	11	29.75	25.00	28.25
04	12.25	7.50	10.75	12	32.25	27.50	30.75
05	14.75	10.00	13.25	13	34.75	30.00	33.25
06	17.25	12.50	15.75	14	37.25	32.50	35.75
07	19.75	15.00	18.25	15	39.75	35.00	38.25
08	22.25	17.50	20.75	16	42.25	37.50	40.75
09	24.75	20.00	23.25				

XYCO 东莞市轩业电子科技有限公司
 TEL: 0769-8297 9981/2/3 <http://www.XYCO.com.cn>

2014-07-24		A	CHANGE HISTORY 變更歷史	KB952-XXHL3A	Devin	TOLERANCE 公差	DRAWING 設計者	Devin	KB952-XXHL3A		UNIT 單位		PRODUCT NAME 產品名稱	XHB PH2.5mm Wire To Board Connector Housing with lock
DATE 日期	VER 版本	CHANGED NAME 修改後料號				DRAWING 變更者	.X=±0.30 .XX=±0.20 .XXX=±0.10	CHECKED 審查	Thomas	PART NO. 料號	mm			
								APPROVED 核准	William	DWG NO. 圖號	PE3603A	⊕		